

DIMENSIONS "TECNIUM" PUMP TYPE:

BNB  
32-125

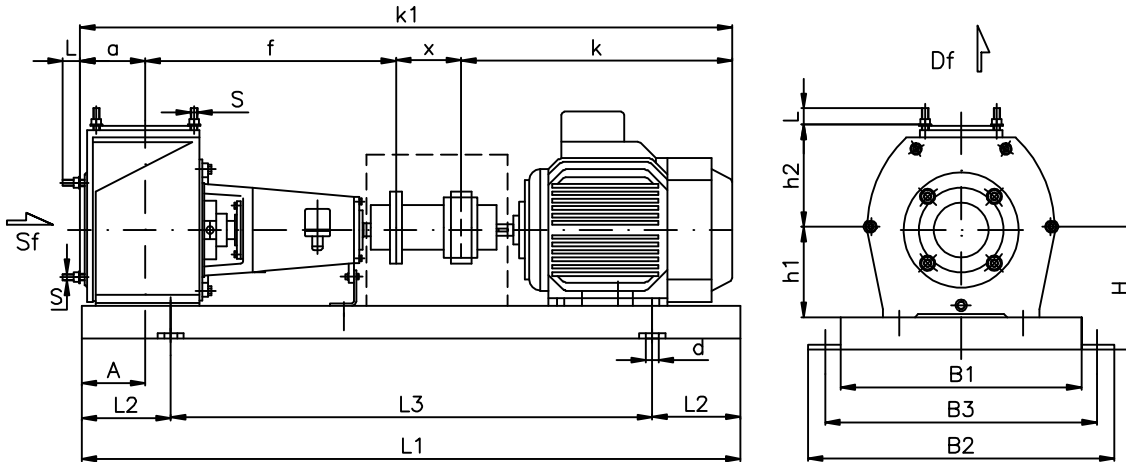

STANDARD	PUMP	BASE PLATE	MOTOR	FLANGES	SPEED RATING/r.p.m.
	DIN EN 22858 ISO 2858 NF E 44121	EN 23661 ISO 3661	NEMA-IP 55	ANSI 150 lbs.	$\frac{1.450}{1.740}$



Pump type	Motor	Pump		Assembly										Base plate Socle N°2				
	Typo	HP	a	f	h1	h2	H	L1	A	B2	k	k1	x	L3	L2	B3	B1	d
BNB 32-125		0.5	3.15	15.16	4.41	5.51	7.91	31.5	2.36	14.17	11.07	33.32	3.94	21.3	5.12	12.6	10.24	0.71

	Df	Sf	Discharge Df	Suction Sf
DN	1-1/4"	2"		
D	4.63"	6"		
C	3.5"	4.75"		
U	2.5"	3.63"		
N°	4	4		
S	1/2"	5/8"		
L	2"	2"		

Coupling } A1

ITEM \_\_\_\_\_

ORDER N: \_\_\_\_\_

Loads in nozzles  
 Traction  $Df 1\frac{1}{4} = 157$  lb.  
 $Sf 2" = 292$  lb.  
 Moment  $Df 1\frac{1}{4} = 8803$  lb.in  
 $Sf 2" = 11444$  lb.in

CLIENT: \_\_\_\_\_

Weight (lbs.)					
Pump	99	Base plate	55	Motor	10.34

Dimensions in inches