

SEP

SEP Series Progressive Cavity Pumps

Shanley Pump  
& Equipment, Inc.



# SEP

## Features

- 9 pump sizes immediately available from our inventory in cast iron and stainless steel
- Shaft packing or mechanical shaft seals available, all standard with shaft wear sleeves
- Flows to 750 GPM, Discharge Pressures to 350 PSI, Suction lift up to 28 feet
- Fluid viscosities to 300,000 Centistokes, Temperatures to 302 degrees Fahrenheit
- Cast Iron pumps have suction clean out/inspection ports
- Lubricated and sealed universal joints for long life

## Design

The Shanley SEP Pump is a progressive cavity pump in 1 and 2 stage design. It's resilient and tested design is optimal for demanding pumping applications. It's ruggedized universal joints with wear bushings are sealed and lubricated from the pumped liquid to provide long service life. The SEP pump is available with equal wall stators for lower starting torque and higher discharge pressures.







**Shanley Pump & Equipment, Inc.**

2525 S. Clearbrook Drive  
Arlington Heights, IL 60005  
P: 847.439.9200  
F: 847.439.9388  
www.shanleypump.com  
sales@shanleypump.com

## Usage

The Shanley SEP Progressive Cavity Pump is an extremely versatile positive displacement pump with a non-pulsating flow that can be used in many different pumping applications. The SEP pump is specially designed for abrasion resistance in tough pumping applications and can pump up to 60% solids. The SEP pump is also ideal for liquids with higher viscosities, or thickness, than water. The gentle pumping action of the SEP pump makes it great for pumping sheer sensitive fluids. The SEP pump is also used for pumping fluids with varying viscosities, for pumping against varying discharge pressures and for pumping applications requiring varying flows using a speed controller. Most commonly used for sludge and polymer at sewage treatment plants, feeding filters and filter presses, centrifuges, feeding oil water separation equipment, food pumping applications like honey, juice concentrate, grapes in wineries, crude oil, viscous chemicals, bilges on ships, coal water slurries and much more.

## Main Applications

-  Municipal waste water sludges & polymer
-  Industrial
-  Food processing
-  Petrochemical

**GPM** 5 - 50 GPM

**PSI** up to 580 PSI

**TEMP** 32°F - +302°F

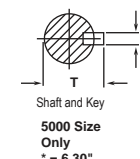
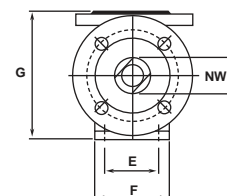
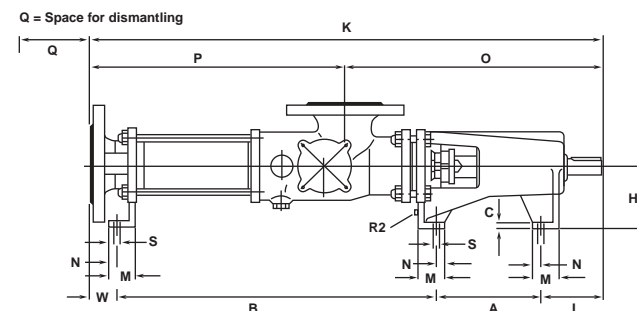
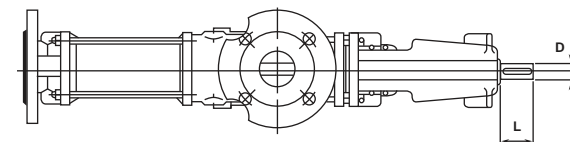

**Dimensions Drawings**

[Click here for complete dimensional drawings](#)



### Performance Curve

For specific applications data on viscosity and pressure please contact us and we send you details about flow rates.



To download our screw pump fax form click here