

speck
pumps 

TOE-MI

Centrifugal Thermal Heat Transfer Pump

**Shanley Pump
& Equipment, Inc.**



TOE-MI

Features

Speck TOE-MI Series Magnetic Drive Centrifugal Thermal Transfer Pumps are designed for the transport and recirculation of organic heat transfer oils on mineral and/or synthetic basis heat transfer applications throughout the world. The TOE-MI Series from Speck Pumps are a vertical "inline" pump design with magnetic drive for applications where space is an issue.

Description

The TOE-MI Series are horizontal magnetic drive close-coupled pumps with end suction. The Direct-Coupled design eliminates the need to align pump and motor shafts.

The Seal-less Magnetic Coupling design also eliminates any temperature misalignment or seal leakage. Suction and Discharge mounting flanges for the TOE- MI Series are drilled to ANSI specifications and the casing is made from ductile cast iron. The TOE- MI performance data is impressive as well. 375 GPM, and 290ft. of Head with oil at temperatures of 625°F.

Suction and Discharge mounting flanges for the Speck TOE- MI Series are ANSI drilled.











Shanley Pump & Equipment, Inc.
 2525 S. Clearbrook Drive
 Arlington Heights, IL 60005
P: 847.439.9200
F: 847.439.9388
 www.shanleypump.com
 sales@shanleypump.com

Usage

Speck TOE- MI Magnetic Drive Centrifugal Thermal Transfer Pumps are available to work in a variety of demanding industries where the movement of heated pumping media is required on a daily basis. Facilities with large baking and frying ovens, heated agitator and mixing tanks, flat glass production, solar power generation stations and ORC processes as well as the color and dye industry all have systems that would benefit from a Speck Thermal Centrifugal Pump.

Main Applications

-  Oil Pumping
-  High Pressure Pumping
-  Boiler Feed Pumping
-  Glass Manufacturing
-  Leather & Rubber Manufacturing
-  Thermal Oil Transfer
-  Thermal Transfer Pumping
-  Baking Industry Pumping

GPM up to 375 GPM

PSI max. 145 PSI

TEMP hot oil up to 625°F

HEAD 290 ft.

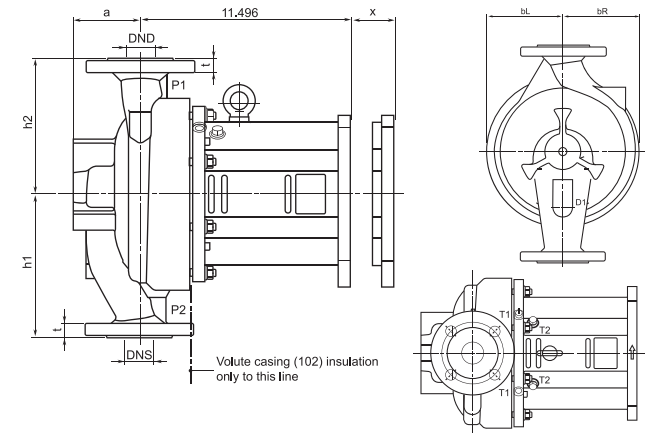

 **Dimensions Drawings**

Please Click The Icon Above For More Information:

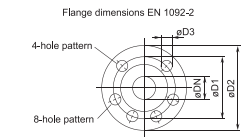

50HZ
Performance Curve

1450 RPM

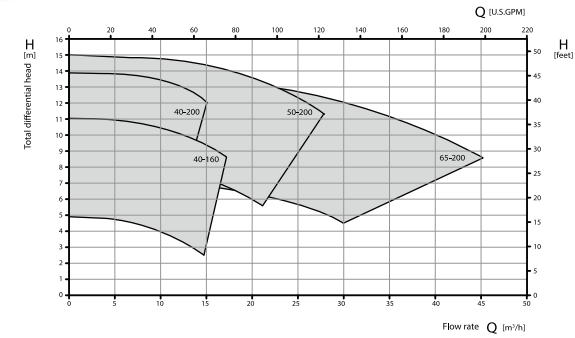

2900 RPM

